

Regulatory Services/Licensing
222 Upper Street, London
N1 1XR

Report of: Director Community Safety, Resilience and Security

Meeting of: Licensing Sub-Committee

Date: 06/02/2024

Ward(s): Clerkenwell

Subject:

PREMISES LICENCE Temporary Event Notice

Re: DRIP, 27 CLERKENWELL ROAD, LONDON EC1M 5RN

1. Synopsis

- 1.1. This is a hearing to determine a Temporary Event Notice (TEN) applied for under section 100, Part 5 of the Licensing Act 2003 in respect of the above premises.
- 1.2. The application was submitted on 29/01/2024 and is seeking to allow:
 - The sale of alcohol, the provision of regulated entertainment and the provision of late-night refreshment from 00:00 to 04:00 on the 17th/18th February 2024.
- 1.3. The premises currently holds a licence allowing:
 - Live music, recorded music, facilities, and performance of dancing, from 09:00 until 02:00 Monday to Sunday.
 - The provision of late-night refreshment, from 23:00 until 02:00 Monday to Sunday
 - The On and Off sales of alcohol. from 08:00 until 02:00 Monday to Sunday

1.4. Relevant Representations:

Metropolitan Police	No:
Noise	Yes:

2. Recommendations

2.1. To determine the TEN under Part 5 of the Licensing Act 2003 as the Licensing Sub-Committee consider appropriate for the promotion of the Licensing Objectives.

2.2. The Committee can decide to:

- i. allow the TEN for the specified event.
- ii. allow the TEN, subject to one or more conditions of the existing premises licence; or
- iii. prohibit the TEN by way of a counter notice.

3. Background

3.1. The premises, both ground floor and first floor, have been licensed by Islington Council for sale of alcohol and regulated entertainments since at least 2005.

3.2. There have been several different owners for this premises, and in 2008 the licence was subject to a summary review.

3.3. The current premises licence holder, SEO Joint Ltd, transferred onto this licence on 18 October 2023.

3.4. An application for a new premises licence by SEO Joint Ltd was received by the Council's Licensing Service on 5th January 2024, to allow licensable activities until 4am on Thursdays to Saturdays.

3.5. The Council's Noise Service submitted a representation in response to this Temporary Event Notice on 1st February 2024, the representation can be found at Appendix 2 of this report.

4. Implications

4.1. Financial Implications

- 4.1.1. The Head of Finance reports that the applicant has paid the application fee of £21:00. Should the application be refused, the fee is not refundable.

4.2. Legal Implications

- 4.2.1. The legal implications are set out in Paragraph 2.
- 4.2.2. Legal advice will be provided at the meeting of the Licensing Sub-Committee as necessary.

4.3. Environmental Implications and contribution to achieving a net zero carbon Islington by 2030

- 4.3.1. The Licensing Sub-Committee need to consider the impacts that that proposals will have on the environment. An impact is defined as any change to the environment, whether positive or negative, wholly, or partially resulting from Council activities. Almost all human activity has some impact on the environment, and it is very unlikely that any activity will not have any implications.

4.4. Equalities Impact Assessment

- 4.4.1. The council must, in the exercise of its functions, have due regard to the need to eliminate discrimination, harassment and victimisation, and to advance equality of opportunity, and foster good relations, between those who share a relevant protected characteristic and those who do not share it (section 149 Equality Act 2010). The council has a duty to have due regard to the need to remove or minimise disadvantages, take steps to meet needs, in particular steps to take account of disabled persons' disabilities, and encourage people to participate in public life. The council must have due regard to the need to tackle prejudice and promote understanding.
- 4.4.2. An Equalities Impact Assessment is not required in relation to this report, because this is a decision relating to a Premises Licence application under the Licensing Act 2003.

5. Conclusion and reasons for recommendations

- 5.1. That the Licensing Sub-Committee determines this application.

Appendices:

Appendix 1: application form.

Appendix 2: representation

Appendix 3: copy of current premises licence

Appendix 4: map of premises location.

Background papers:

- None.

Final report clearance:

Authorised by:

Terrie Lane

Licensing Manager

Date:

02/02/2024

Report author: Licensing Service

Tel: 020 75027 3031

E-mail: licensing@islington.gov.uk



**Islington Council
Temporary Event Notice
Licensing Act 2003**

For help contact
licensing@islington.gov.uk
Telephone: 020 7527 3031

* required information

Section 1 of 9

You can save the form at any time and resume it later. You do not need to be logged in when you resume.

System reference This is the unique reference for this application generated by the system.

Your reference You can put what you want here to help you track applications if you make lots of them. It is passed to the authority.

Are you an agent acting on behalf of the applicant? Put "no" if you are applying on your own behalf or on behalf of a business you own or work for.

- Yes
- No

Applicant Details

* First name

* Family name

* E-mail

Main telephone number Include country code.

Other telephone number

Indicate here if the applicant would prefer not to be contacted by telephone

Is the applicant:

- Applying as a business or organisation, including as a sole trader
- Applying as an individual

A sole trader is a business owned by one person without any special legal structure. Applying as an individual means the applicant is applying so the applicant can be employed, or for some other personal reason, such as following a hobby.

Continued from previous page...

Address

* Building number or name	<input type="text"/>
* Street	<input type="text"/>
District	<input type="text"/>
* City or town	<input type="text"/>
County or administrative area	<input type="text"/>
* Postcode	<input type="text"/>
* Country	<input type="text"/>

Agent Details

* First name	<input type="text" value="Guy"/>
* Family name	<input type="text" value="Hicks"/>
* E-mail	<input type="text"/>
Main telephone number	<input type="text"/>
Other telephone number	<input type="text"/>

Include country code.

Indicate here if you would prefer not to be contacted by telephone

Are you:

- An agent that is a business or organisation, including a sole trader
- A private individual acting as an agent

A sole trader is a business owned by one person without any special legal structure.

Your Address

Address official correspondence should be sent to.

* Building number or name	<input type="text"/>
* Street	<input type="text"/>
District	<input type="text"/>
* City or town	<input type="text"/>
County or administrative area	<input type="text"/>
* Postcode	<input type="text"/>
* Country	<input type="text"/>

Section 2 of 9

APPLICATION DETAILS [\(See also guidance on completing the form, general notes and note 1\)](#)

Continued from previous page...

Have you had any previous or maiden names?

- Yes No

* Your date of birth

/ /
dd mm yyyy

Applicant must be 18 years of age or older

National Insurance number

This box need not be completed if you are an individual not liable to pay UK national insurance.

Place of birth

Correspondence Address

Is the address the same as (or similar to) the address given in section one?

- Yes No

If "Yes" is selected you can re-use the details from section one, or amend them as required. Select "No" to enter a completely new set of details.

Building number or name

Street

District

City or town

County or administrative area

Postcode

Country

Additional Contact Details

Are the contact details the same as (or similar to) those given in section one?

- Yes No

If "Yes" is selected you can re-use the details from section one, or amend them as required. Select "No" to enter a completely new set of details.

E-mail

Telephone number

Other telephone number

Section 3 of 9

THE PREMISES

I, the proposed user, hereby give notice under section 100 of the Licensing Act 2003 of my proposal to carry out a temporary activity at the premises described below.

Give the address of the premises where you intend to carry on the licensable activities or if it has no address give a detailed description (including the Ordnance Survey references). ([See also guidance on completing the form, note 2](#))

* Does the premises have an address?

- Yes No

Continued from previous page...

Address

Is the address the same as (or similar to) the address given in section one?

If "Yes" is selected you can re-use the details from section one, or amend them as required. Select "No" to enter a completely new set of details.

- Yes No

* Building number or name

* Street

District

* City or town

County or administrative area

* Postcode

* Country

* Does a premises licence or club premises certificate have effect in relation to the premises (or any part of the premises)?

- Neither Premises licence Club premises certificate

* Premises licence number

Location Details

* Provide further details about the location of the event

Event is within 27 Clerkenwell road over 2 floors, Ground and First.

If you intend to use only part of the premises at this address or intend to restrict the area to which this notice applies, give a description and details below [\(see also guidance on completing the form, note 3\)](#)

Whole of premises.

Describe the nature of the premises below [\(see also guidance on completing the form, note 4\)](#)

The premises is a bar with dance area, music and cocktails.

Describe the nature of the event below [\(see also guidance on completing the form, note 5\)](#)

The operator would like extra hours for licensable activity for a ticket only event with DJ, singer and live band.

Section 4 of 9

LICENSABLE ACTIVITIES

State the licensable activities that you intend to carry on at the premises
(see also [guidance on completing the form, note 6](#)):

- The sale by retail of alcohol
- The supply of alcohol by or on behalf of a club to, or to the order of, a member of the club
- The provision of regulated entertainment
- The provision of late night refreshment
- The giving of a late temporary event notice

(See also [guidance on completing the form, note 7](#)).

Late notices can be given no later than 5 working days but no earlier than 9 working days before the event.

(See also [guidance on completing the form, note 8](#)).

Event Dates

There must be a period of at least 10 working days between the date you submit this form and the date of the earliest event when you will be using these premises for licensable activities.

State the dates on which you intend to use these premises for licensable activities

(see also [guidance on completing the form, note 9](#))

Event start date / /
dd mm yyyy

The maximum period for using premises for licensable activities under the authority of a temporary event notice is 168 hours or seven days.

Event end date / /
dd mm yyyy

State the times during the event period that you propose to carry on licensable activities (give times in 24 hour clock)

(see also [guidance on completing the form, note 10](#))

State the maximum number of people at any one time that you intend to allow to be present at the premises during the times when you intend to carry on licensable activities, including any staff, organisers or performers

(see also [guidance on completing the form, note 11](#))

Note that the maximum number of people cannot exceed 499.

Continued from previous page...

If the licensable activities will include the supply of alcohol, state whether the supplies will be for consumption on or off the premises, or both

[\(see also guidance on completing the form, note 12\):](#)

- On the premises only
- Off the premises only
- Both

Section 5 of 9

RELEVANT ENTERTAINMENT [\(See also guidance on completing the form, note 13\)](#)

State if the licensable activities will include the provision of relevant entertainment. If so, state the times during the event period that you propose to provide relevant entertainment

There will be no activity of this nature.

Section 6 of 9

PERSONAL LICENCE HOLDERS [\(See also guidance on completing the form, note 14\)](#)

Do you currently hold a valid personal licence? Yes No

Provide the details of your personal licence below.

Issuing licensing authority

Licence number

Date of issue / /
dd mm yyyy

Any further relevant details

Section 7 of 9

PREVIOUS TEMPORARY EVENT NOTICES [\(See also guidance on completing the form, note 15\)](#)

Have you previously given a temporary event notice in respect of any premises for events falling in the same calendar year as the event for which you are now giving this temporary event notice? Yes No

Continued from previous page...

State the number of temporary event notices (including the number of late temporary event notices, if any) you have given for events in that same calendar year

3

Have you already given a temporary event notice for the same premises in which the event period:

- a) Ends 24 hours or less before; or Yes No
- b) Begins 24 hours or less after the event period proposed in this notice?

Section 8 of 9

ASSOCIATES AND BUSINESS COLLEAGUES [\(See also guidance on completing the form, note 16\)](#)

Has any associate of yours given a temporary event notice for an event in the same calendar year as the event for which you are now giving a temporary event notice?

Yes No

Has any associate of yours already given a temporary event notice for the same premises in which the event period:

- a) Ends 24 hours or less before; or Yes No
- b) Begins 24 hours or less after the event period proposed in this notice?

Has any person with whom you are in business carrying on licensable activities given a temporary event notice for an event in the same calendar year as the event for which you are now giving a temporary event notice?

Yes No

Continued from previous page...

Has any person with whom you are in business carrying on licensable activities already given a temporary event notice for the same premises in which the event period:

Yes No

- a) Ends 24 hours or less before; or
- b) Begins 24 hours or less after the event period proposed in this notice?

Section 9 of 9

CONDITION [\(See also guidance on completing the form, note 18\)](#)

It is a condition of this temporary event notice that where the relevant licensable activities described in Sections 4 and 5 above include the supply of alcohol that all such supplies are made by or under the authority of the premises user.

PAYMENT DETAILS

This fee must be paid to the authority. If you complete the application online, you must pay it by debit or credit card.

This formality requires a fixed fee of £21

DECLARATION [\(See also guidance on completing the form, note 19\)](#)

- * The information contained in this form is correct to the best of my knowledge and belief
 - * I understand that it is an offence:
 - * (i) to knowingly or recklessly make a false statement in connection with this temporary event notice and that a person is liable on conviction for such an offence to a fine up to level 5 on the standard scale; and
 - * (ii) to permit an unauthorised licensable activity to be carried on at any place and that a person is liable on conviction for any such offence to a fine not exceeding £20,000, or to imprisonment for a term not exceeding six months, or to both
- Ticking this box indicates you have read and understood the above declaration

This section should be completed by the applicant, unless you answered "Yes" to the question "Are you an agent acting on behalf of the applicant?"

* Full name

* Capacity

* Date / /
dd mm yyyy

Once you're finished you need to do the following:

1. Save this form to your computer by clicking file/save as...
2. Go back to <https://www.gov.uk/apply-for-a-licence/temporary-event-notice/islington/apply-1> to upload this file and continue with your application.

Don't forget to make sure you have all your supporting documentation to hand.

OFFICE USE ONLY

Applicant reference number	<input type="text" value="Drip/2/24"/>
Fee paid	<input type="text"/>
Payment provider reference	<input type="text"/>
ELMS Payment Reference	<input type="text"/>
Payment status	<input type="text"/>
Payment authorisation code	<input type="text"/>
Payment authorisation date	<input type="text"/>
Date and time submitted	<input type="text"/>
Approval deadline	<input type="text"/>
Error message	<input type="text"/>
Is Digitally signed	<input type="checkbox"/>

From: Santis, Fanos <Fanos.Santis@islington.gov.uk>
Sent: Thursday, February 1, 2024 3:46 PM
To: Burrell, Ryan <Ryan.Burrell@islington.gov.uk>;
CNMailbox-.IslingtonPoliceLicensingTeam@met.police.uk; Jones, Carol <Carol.Jones@islington.gov.uk>
Cc: Lane, Terrie <Teresa.Lane@islington.gov.uk>; Ford, Andrew <Andrew.Ford@islington.gov.uk>
Subject: RE: TEN RA: Drip London, BASEMENT to FIRST, 27 Clerkenwell Road, London, EC1M 5RN.

Dear all,

The Pollution Team objects to the TEN due to several complaints received in the last couple of weeks.

Complaint received on 20/01/24, 03:24. Officers called back at 03:57 but music ad stopped.

Complaint received on 21/01/24, 00:52. Officers called back at 01:08 but no response from reporter.

Complaint received on 21/01/24, 19:44. Officers called back at , no answer. Officers visited at 21:21 but no noise audible from outside.

Complaint received on 21/01/24, 23:06. Officers called back at 23:20, no response. Officers visited at 00:04 and made assessment outside. The doors were shut but could hear low level bass coming from the venue. Officers decided that levels not loud enough to intervene unless they could assess from within the reporter's residence.

Complaint received on 29/01/24, 01:20. Officers called back at 01:25, no response. Officers visited location at 01:36. Loud music and bass audible from outside, approximately 20 metres away. They visited the venue and spoke to the supervisor, known as Mark. They made him aware of the noise issue and asked if there was a noise limiter, he replied yes and the officers asked if they could view it. Mark told them that the limiter was not set up. The noise was reduced and officers left at 01:54.

Complaint received on 30/01/24, 23:35. Officers called back at 23:46 but had no response. Location visited by officers at 02:30, no noise witnessed outside.

Complaint received on 31/01/24 at 00:56. Officers called back at 01:25 but no response. Location visited at 02:30, no noise witnessed outside.

The licensee had made an application for a premises licence on the 5th January 2024. A representation was made following an objection by the pollution team, with conditions to control any noise issues received. These so far to date have not been agreed.

Further to my objection to the TEN, a previous TEN had been objected to in December 2023 and the

representative informed that noise limiter(s) would be set up. To date, the pollution team has not received any calibration certificate. Based on the visit carried out by our ASB officers on the 29th January 2024, the limiter had not been set up.

The pollution team is of the opinion that if the TEN is allowed and the event goes ahead, local residents will be disturbed.

Kind regards,

Fanos Santis
Senior Environmental Health Officer,
Environmental Pollution, Policy and Projects Team,
Climate Change and Transport Division,
Environment and Climate Change Department,
Islington Council, 2nd Floor, Waste Recycling Centre,
1 Cottage Rd, London N7 8TP
Tel: 020 7527 3963, email:fanos.santis@islington.gov.uk, www.islington.gov.uk

NB: I am now part time and work only Tuesdays, Wednesdays and Thursdays.

The information contained in this E-Mail may be subject to public disclosure under the Freedom of Information Act 2000. Unless the information is legally exempt from disclosure, the confidentiality of this E-Mail and your reply cannot be guaranteed.

The information in this message is confidential and may be legally privileged. It is intended solely for the addressee. Access to this message by any other person is not permitted. If you are not the intended recipient, any disclosure, copying, distribution or any action taken or omitted to be taken in reliance on it, is prohibited and may be unlawful.

Follow us on Twitter @IslingtonBC and @IslingtonLife
Like us on Facebook @IslingtonBC and @IslingtonLife
Follow IslingtonLife on Instagram @IslingtonLife

The image is a composite of two parts. The top part is a banner with the text 'Towards a Fairer Islington' in green and 'Our Commitment' in yellow. Below this, it says 'Visit www.islington.gov.uk/corporateplan'. To the right are six colorful hexagons containing icons and labels: 'HOMES' (house icon), 'WORK' (briefcase icon), 'MONEY' (coin icon), 'GOOD SERVICES' (thumbs up icon), and 'QUALITY OF LIFE' (sun icon). The bottom part is an advertisement with an orange background on the left and a photo of a smiling woman on the right. The text on the left says 'We're helping with the cost of living crisis' and provides contact information: 'Call 020 7527 8222', 'email heretohelp@islington.gov.uk', and 'Visit islington.gov.uk/costofliving'. The Islington logo is in the bottom right corner of the advertisement.

From: Burrell, Ryan <Ryan.Burrell@islington.gov.uk>

Sent: Tuesday, January 30, 2024 2:02 PM

To: CNMailbox-IslingtonPoliceLicensingTeam@met.police.uk; Jones, Carol <Carol.Jones@islington.gov.uk>

Cc: Lane, Terrie <Teresa.Lane@islington.gov.uk>; Santis, Fanos <Fanos.Santis@islington.gov.uk>; Ford,

Andrew <Andrew.Ford@islington.gov.uk>

Subject: TEN RA: Drip London, BASEMENT to FIRST, 27 Clerkenwell Road, London, EC1M 5RN.

Dear RA,

We have received the following attached application(s) for a **STANDARD TEMPORARY EVENT NOTICE**:

Worksheet Number: WK/230042847

Applicant Details: Owen Igbinovia, [REDACTED]

Premises: Drip London,

Address: BASEMENT to FIRST, 27 Clerkenwell Road, London, EC1M 5RN.

Date of Event: 17/02/2024 – 18/02/2024

Timings of Event: 00:00 – 04:00

Received on: 29/01/2024

Last Date of Repls: 01/02/2024

Ryan Burrell

Licensing Support Officer

Licensing

Community Safety, Resilience and Security

Islington Council

222 Upper Street, N1 1XR

Direct Tel: **020 7527 4330**

Licensing Duty Line: **020 7527 3031** or email licensing@islington.gov.uk

Follow us on Twitter [@IslingtonBC](https://twitter.com/IslingtonBC) and [@IslingtonLife](https://twitter.com/IslingtonLife)

Like us on Facebook [@IslingtonBC](https://www.facebook.com/IslingtonBC) and [@IslingtonLife](https://www.facebook.com/IslingtonLife)

Follow IslingtonLife on Instagram [@IslingtonLife](https://www.instagram.com/IslingtonLife)

The information contained in this E-Mail may be subject to public disclosure under the Freedom of Information Act 2000. Unless the information is legally exempt from disclosure, the confidentiality of this E-Mail and your reply cannot be guaranteed. It is intended solely for the addressee. If you are not the intended recipient, any disclosure, copying, distribution or any action taken or omitted to be taken in reliance on it, is prohibited and may be unlawful.

**PREMISES LICENCE
LICENSING ACT 2003**

Premises licence number	LN [REDACTED]	Date of original grant*	24 November 2005
--------------------------------	---------------	--------------------------------	------------------

**An annual fee associated with this licence is to be paid on the anniversary of the original grant date.*

Postal address of premises, or if none, ordnance survey map reference or description			
DRIP LONDON 27 CLERKENWELL ROAD			
Post town	London	Post code	EC1M 5RN
Telephone number	[REDACTED]		

Where the licence is time limited the dates
Not Applicable

Licensable activities authorised by the licence
Ground & First Floor
<ul style="list-style-type: none"> • The provision of regulated entertainment by way of: <ul style="list-style-type: none"> The performance of live music The playing of recorded music The performance of dance • The provision of entertainment facilities for: <ul style="list-style-type: none"> Making music Dancing • The provision of late night refreshment • The sale by retail of alcohol

The times the licence authorises the carrying out of licensable activities																																																																										
<ul style="list-style-type: none"> • The provision of regulated entertainment for the performance of live music: <table style="width: 100%; border-collapse: collapse;"> <tr> <td style="width: 15%;">Monday</td> <td style="width: 15%;">09:00</td> <td style="width: 5%;">to</td> <td style="width: 15%;">02:00</td> <td style="width: 55%;">the following day</td> </tr> <tr> <td>Tuesday</td> <td>09:00</td> <td>to</td> <td>02:00</td> <td>the following day</td> </tr> <tr> <td>Wednesday</td> <td>09:00</td> <td>to</td> <td>02:00</td> <td>the following day</td> </tr> <tr> <td>Thursday</td> <td>09:00</td> <td>to</td> <td>02:00</td> <td>the following day</td> </tr> <tr> <td>Friday</td> <td>09:00</td> <td>to</td> <td>02:00</td> <td>the following day</td> </tr> <tr> <td>Saturday</td> <td>09:00</td> <td>to</td> <td>02:00</td> <td>the following day</td> </tr> <tr> <td>Sunday</td> <td>09:00</td> <td>to</td> <td>02:00</td> <td>the following day</td> </tr> </table> • The provision of regulated entertainment for the playing of recorded music: <table style="width: 100%; border-collapse: collapse;"> <tr> <td style="width: 15%;">Monday</td> <td style="width: 15%;">09:00</td> <td style="width: 5%;">to</td> <td style="width: 15%;">02:00</td> <td style="width: 55%;">the following day</td> </tr> <tr> <td>Tuesday</td> <td>09:00</td> <td>to</td> <td>02:00</td> <td>the following day</td> </tr> <tr> <td>Wednesday</td> <td>09:00</td> <td>to</td> <td>02:00</td> <td>the following day</td> </tr> <tr> <td>Thursday</td> <td>09:00</td> <td>to</td> <td>02:00</td> <td>the following day</td> </tr> <tr> <td>Friday</td> <td>09:00</td> <td>to</td> <td>02:00</td> <td>the following day</td> </tr> <tr> <td>Saturday</td> <td>09:00</td> <td>to</td> <td>02:00</td> <td>the following day</td> </tr> <tr> <td>Sunday</td> <td>09:00</td> <td>to</td> <td>02:00</td> <td>the following day</td> </tr> </table> 					Monday	09:00	to	02:00	the following day	Tuesday	09:00	to	02:00	the following day	Wednesday	09:00	to	02:00	the following day	Thursday	09:00	to	02:00	the following day	Friday	09:00	to	02:00	the following day	Saturday	09:00	to	02:00	the following day	Sunday	09:00	to	02:00	the following day	Monday	09:00	to	02:00	the following day	Tuesday	09:00	to	02:00	the following day	Wednesday	09:00	to	02:00	the following day	Thursday	09:00	to	02:00	the following day	Friday	09:00	to	02:00	the following day	Saturday	09:00	to	02:00	the following day	Sunday	09:00	to	02:00	the following day
Monday	09:00	to	02:00	the following day																																																																						
Tuesday	09:00	to	02:00	the following day																																																																						
Wednesday	09:00	to	02:00	the following day																																																																						
Thursday	09:00	to	02:00	the following day																																																																						
Friday	09:00	to	02:00	the following day																																																																						
Saturday	09:00	to	02:00	the following day																																																																						
Sunday	09:00	to	02:00	the following day																																																																						
Monday	09:00	to	02:00	the following day																																																																						
Tuesday	09:00	to	02:00	the following day																																																																						
Wednesday	09:00	to	02:00	the following day																																																																						
Thursday	09:00	to	02:00	the following day																																																																						
Friday	09:00	to	02:00	the following day																																																																						
Saturday	09:00	to	02:00	the following day																																																																						
Sunday	09:00	to	02:00	the following day																																																																						

- The provision of regulated entertainment for the performance of dance:

Monday	09:00	to	02:00	the following day
Tuesday	09:00	to	02:00	the following day
Wednesday	09:00	to	02:00	the following day
Thursday	09:00	to	02:00	the following day
Friday	09:00	to	02:00	the following day
Saturday	09:00	to	02:00	the following day
Sunday	09:00	to	02:00	the following day

- The provision of entertainment facilities for making music:

Monday	09:00	to	02:00	the following day
Tuesday	09:00	to	02:00	the following day
Wednesday	09:00	to	02:00	the following day
Thursday	09:00	to	02:00	the following day
Friday	09:00	to	02:00	the following day
Saturday	09:00	to	02:00	the following day
Sunday	09:00	to	02:00	the following day

- The provision of entertainment facilities for dancing:

Monday	09:00	to	02:00	the following day
Tuesday	09:00	to	02:00	the following day
Wednesday	09:00	to	02:00	the following day
Thursday	09:00	to	02:00	the following day
Friday	09:00	to	02:00	the following day
Saturday	09:00	to	02:00	the following day
Sunday	09:00	to	02:00	the following day

- The provision of late night refreshment:

Monday	23:00	to	02:00	the following day
Tuesday	23:00	to	02:00	the following day
Wednesday	23:00	to	02:00	the following day
Thursday	23:00	to	02:00	the following day
Friday	23:00	to	02:00	the following day
Saturday	23:00	to	02:00	the following day
Sunday	23:00	to	02:00	the following day

- The sale by retail of alcohol:

Monday	08:00	to	02:00	the following day
Tuesday	08:00	to	02:00	the following day
Wednesday	08:00	to	02:00	the following day
Thursday	08:00	to	02:00	the following day
Friday	08:00	to	02:00	the following day
Saturday	08:00	to	02:00	the following day
Sunday	08:00	to	02:00	the following day

The opening hours of the premises:

Not Specified

Where the licence authorises supplies of alcohol whether these are on and/or off supplies

On and off supplies (off supplies in sealed container only)

Name, (registered) address, telephone number and e-mail (where relevant) of holder of premises licence

SEO Joint Ltd

[REDACTED]

[REDACTED]

[REDACTED]

Registered number of holder, for example company number, charity number (where applicable)

[REDACTED]

Name, address and telephone number of designated premises supervisor where the premises licence authorises the supply of alcohol

Paul Villanueva

[REDACTED]

[REDACTED]

[REDACTED]

[REDACTED]

Personal licence number and issuing authority of personal licence held by designated premises supervisor where the premises licence authorises the supply of alcohol

[REDACTED]

Licensing Service
Regulatory Services
Community Safety, Security and Resilience
222 Upper Street
London
N1 1XR
licensing@islington.gov.uk
020 7527 3031

Licensing Authority

Date of Issue

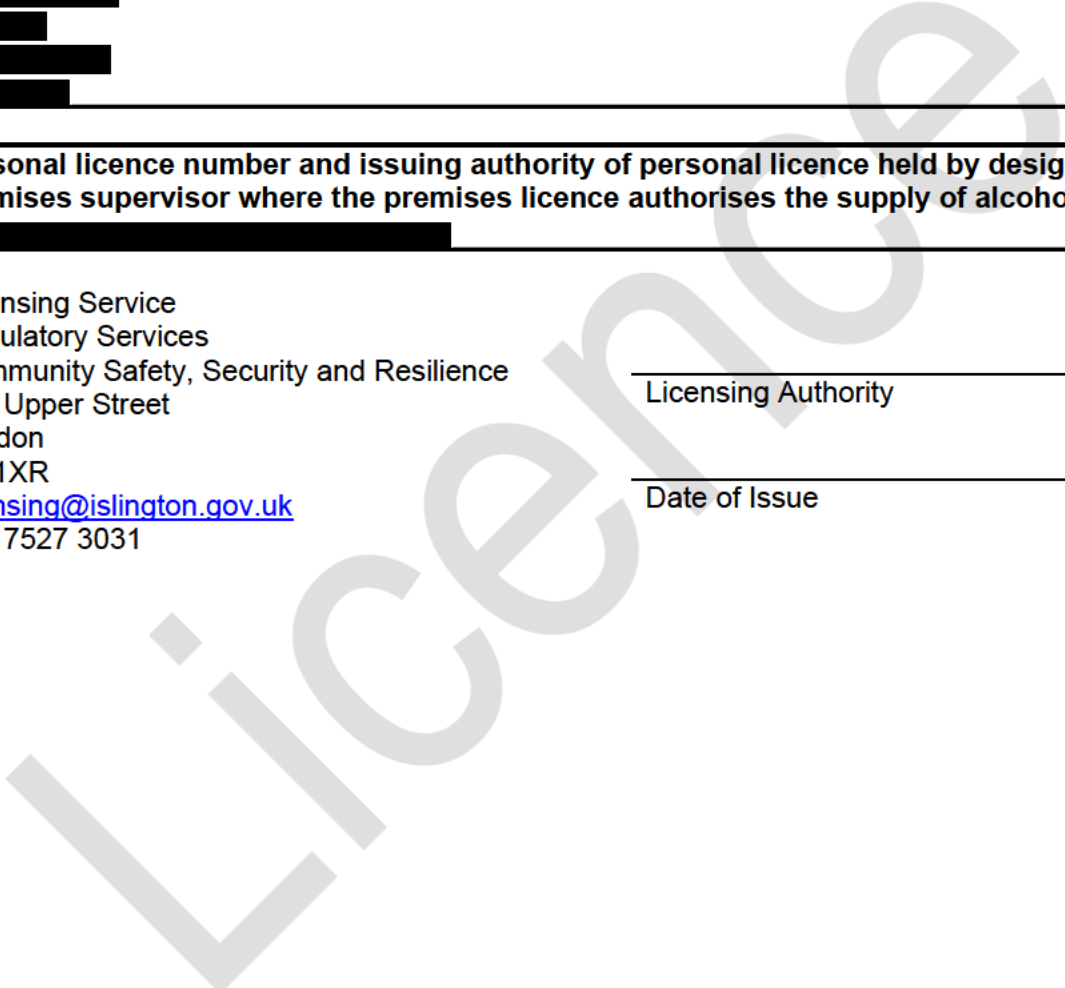

Annex 1 - Mandatory conditions

1. No supply of alcohol may be made under the premises licence:
 - a) at a time when there is no designated premises supervisor in respect of the premises licence, or
 - b) at a time when the designated premises supervisor does not hold a personal licence or his personal licence is suspended.
2. Every supply of alcohol under the premises licence must be made or authorised by a person who holds a personal licence.
3. All door supervisors shall be licensed by the Security Industry Authority.
4. The admission of children to the exhibition of a film shall be restricted in accordance with the recommendation of a film classification body as defined in the Video Recordings Act 1984 or Islington Council acting as the licensing authority where it has given notice in section 20(3) of the Licensing Act 2003.

There are further 'Mandatory conditions' applicable to licences authorising the supply of alcohol. A full list of the current mandatory conditions is available from the licensing pages on Islington's web site, www.islington.gov.uk. This list is subject to change by order of the Secretary of State and licensees and other responsible persons are advised to ensure they are aware of the latest conditions.

Annex 2 - Conditions consistent with the Operating Schedule

1. Alcohol shall not be sold, supplied, consumed in or taken from the premises except during permitted hours. In this condition permitted hours mean the authorised hours specified on this licence for the sale of retail of alcohol. This restriction does not prohibit:
 - a) During the first twenty minutes after the above hours, the consumption of the alcohol on the premises;
 - b) During the first twenty minutes after the above hours, the taking of the alcohol from the premises unless the alcohol is supplied or taken in an open vessel;
 - c) During the first thirty minutes after the above hours, the consumption of the alcohol on the premises by persons taking meals there if alcohol was supplied for consumption as ancillary to the meals;
 - d) Consumption of the alcohol on the premises or the taking of sale or supply of alcohol to any persons residing in the licensed premises;
 - e) The ordering of alcohol to be consumed off the premises, or the despatch by the vendor of the alcohol so ordered;
 - f) The sale of alcohol to a trader or club for the purposes of the trade or club;
 - g) The sale or supply of alcohol to any canteen or mess, being a canteen in which the sale or supply of alcohol is carried out under the authority of the Secretary of State or an authorised mess of members of Her Majesty's naval, military or air forces;
 - h) The taking of alcohol from the premises by a person residing there; or
 - i) The supply of alcohol for consumption on the premises to any private friends of a person residing there who are bona fide entertained by him at his own expense, or the consumption of alcohol by persons so supplied; or
 - j) The supply of alcohol for consumption on the premises to persons employed there for the purposes of the business carried on by the holder of the licence, or the consumption of liquor so supplied, if the liquor is supplied at the expense of their employer or of the person carrying on or in charge of the business on the premises.
2. The entertainment noise limiting device installed shall be calibrated so that the following maximum internal levels are not exceeded:

For the ground floor (a) 101 dB Leq 1 min. linear & 88 dBA Laeq 1 min. on the dance floor & 99 dB Leq 1 min. Linear & 88 dBA Laeq 1 min. in the front bar area (b). In addition the un-weighted sound pressure level in the octave band 63 Hz shall not exceed 97 dB & at 125 Hz a level of 102 dB shall not be exceeded.

For the first floor (a) 100 dB Leq 1 min. linear & 92 dBA Laeq 1 min. (b). In addition the un-weighted sound pressure level in the octave band 63 Hz shall not exceed 92 dB & at 125 Hz a level of 99 dB shall not be exceeded.

3. The licensee or their appointed deputy shall be the only persons authorised to have access to the entertainment limiter controls; DJs, performers or junior members of staff are not allowed access.
4. Notices shall be displayed within the premises, visible at all exit point from the ground and first floor areas, encouraging patrons to disperse from the vicinity of the premises quickly and quietly.
5. The staff door at the rear of the premises shall not be left open.
6. There shall be a "Challenge 21" policy in operation at the premises whereby any individual who appears to be under the age of 21 years shall be required to produce proof that they are at least 18 years by way of one of the following forms of identification:
 - A PASS accredited proof of age card
 - Photocard driving licence
 - Passport
 - Citizen card supported by the Home Office
 - Official ID card issued by HM Forces or European Union bearing photograph and date of birth of holder
 - Any other form of identification agreed with the Police.
7. All staff shall receive regular training in relation to the "Challenge 21" policy and such training will be documented and made available for inspection upon demand by any officer authorised in accordance with the Licensing Act 2003.
8. CCTV shall be installed at the premises. The CCTV system shall comply with the following criteria:
 - The CCTV system shall be installed, maintained and operated to the reasonable satisfaction of the Police.
 - The system shall display on any recording the correct time and date of the recording.
 - The system shall be recording during all hours the premises is open to the public.
 - VCR tapes or digital recordings shall be held for a minimum of 28 days after the recording is made and will be made available for Police for inspection upon request.
9. No person under 18 years of age shall be allowed on the premises after 22:00 hours.
10. In the event of a noise nuisance in respect of amplified sound at the premises is reported to and subsequently witnessed and appropriately substantiated by an authorised officer of the council, a noise limiting device will be installed at the premises which will control all amplified music and sound. Said device will cut the power supply to the sound system if the pre-set music levels are being exceeded. The device shall be installed and calibrated and music levels set to the Council's satisfaction and the calibration certificate forwarded to the licensing team within 28 days of the Premises Licence Holder being notified in writing of the alleged noise nuisance.

11. In the event that a noise limiting device is installed at the premises in accordance with the preceding condition, an acoustic consultant or sound engineer who is a member of the Institute of Acoustics or Association of Noise Consultants shall calibrate the device annually to ensure the pre-set music levels are not being exceed. The calibration certificate shall be forwarded to the Licensing Team 28 days before the anniversary of the installation of the noise-limiting device.
12. Following the installation of any noise-limiting device which is installed in accordance with the two preceding conditions, if there are any subsequent changes in the distribution and type of loudspeakers or amplification equipment serving the in house sound systems, then the noise control systems shall be re-calibrated by an acoustic consultant or sound engineer who is a member of the Institute of Acoustics or Association of Noise Consultants to ensure the pre-set music levels are not being exceeded. The calibration certificated shall be forwarded to the Licensing Team within 28 days of the change.
13. Windows and doors to the premises will be kept closed, except for entry and exit and for health and safety reasons, at all times when noise generating regulated entertainment is taking place.
14. Prominent, clear and legible notices must be displayed at all public exits requesting the public to respect the needs of local residents and to leave the premises and area quietly.
15. The management and staff will not permit drinks in an unsealed container to be taken outside at any time.
16. Unless otherwise agreed with the Police, SIA registered door supervisors will be utilised at the premises on a Friday and Saturday evening at a rate of one door supervisor per 150 customers from 22:00 until 30 minutes after the last patrons have departed.
17. The maximum number of persons accommodated at any one time in the premises shall not exceed the following:
 - Ground Floor - 100
 - First Floor - 50

Annex 3 - Conditions attached after a hearing by the licensing authority

None

Annex 4 – Plans

Reference Number: LN6059-050511

Premises Licence Summary

Licensing Act 2003

Premises licence number	LN/6059-011123	Date of original grant*	24 November 2005
--------------------------------	----------------	--------------------------------	------------------

**An annual fee associated with this licence is to be paid on the anniversary of the original grant date.*

Postal address of premises, or if none, ordnance survey map reference or description			
DRIP LONDON 27 CLERKENWELL ROAD			
Post town	London	Post code	EC1M 5RN
Telephone number	020 7490 5120		

Where the licence is time limited the dates
Not Applicable

Licensable activities authorised by the licence
Ground & First Floor
<ul style="list-style-type: none"> • The provision of regulated entertainment by way of: The performance of live music The playing of recorded music The performance of dance • The provision of entertainment facilities for: Making music Dancing • The provision of late night refreshment • The sale by retail of alcohol

The times the licence authorises the carrying out of licensable activities				
<ul style="list-style-type: none"> • The provision of regulated entertainment for the performance of live music: 				
Monday	09:00	to	02:00	the following day
Tuesday	09:00	to	02:00	the following day
Wednesday	09:00	to	02:00	the following day
Thursday	09:00	to	02:00	the following day
Friday	09:00	to	02:00	the following day
Saturday	09:00	to	02:00	the following day
Sunday	09:00	to	02:00	the following day
<ul style="list-style-type: none"> • The provision of regulated entertainment for the playing of recorded music: 				
Monday	09:00	to	02:00	the following day
Tuesday	09:00	to	02:00	the following day
Wednesday	09:00	to	02:00	the following day
Thursday	09:00	to	02:00	the following day
Friday	09:00	to	02:00	the following day
Saturday	09:00	to	02:00	the following day
Sunday	09:00	to	02:00	the following day

- The provision of regulated entertainment for the performance of dance:

Monday	09:00	to	02:00	the following day
Tuesday	09:00	to	02:00	the following day
Wednesday	09:00	to	02:00	the following day
Thursday	09:00	to	02:00	the following day
Friday	09:00	to	02:00	the following day
Saturday	09:00	to	02:00	the following day
Sunday	09:00	to	02:00	the following day

- The provision of entertainment facilities for making music:

Monday	09:00	to	02:00	the following day
Tuesday	09:00	to	02:00	the following day
Wednesday	09:00	to	02:00	the following day
Thursday	09:00	to	02:00	the following day
Friday	09:00	to	02:00	the following day
Saturday	09:00	to	02:00	the following day
Sunday	09:00	to	02:00	the following day

- The provision of entertainment facilities for dancing:

Monday	09:00	to	02:00	the following day
Tuesday	09:00	to	02:00	the following day
Wednesday	09:00	to	02:00	the following day
Thursday	09:00	to	02:00	the following day
Friday	09:00	to	02:00	the following day
Saturday	09:00	to	02:00	the following day
Sunday	09:00	to	02:00	the following day

- The provision of late night refreshment:

Monday	23:00	to	02:00	the following day
Tuesday	23:00	to	02:00	the following day
Wednesday	23:00	to	02:00	the following day
Thursday	23:00	to	02:00	the following day
Friday	23:00	to	02:00	the following day
Saturday	23:00	to	02:00	the following day
Sunday	23:00	to	02:00	the following day

- The sale by retail of alcohol:

Monday	08:00	to	02:00	the following day
Tuesday	08:00	to	02:00	the following day
Wednesday	08:00	to	02:00	the following day
Thursday	08:00	to	02:00	the following day
Friday	08:00	to	02:00	the following day
Saturday	08:00	to	02:00	the following day
Sunday	08:00	to	02:00	the following day

Where the licence authorises supplies of alcohol whether these are on and/or off supplies

On and off supplies (off supplies in sealed container only)

Name, (registered) address of holder of premises licence

SEO Joint Ltd
27 Clerkenwell Road
London
EC1M 5RN

Registered number of holder, for example company number, charity number (where applicable)

14659924

Name of designated premises supervisor where the premises licence authorises the supply of alcohol

Paul Villanueva

State whether access to the premises by children is restricted or prohibited

No person under 18 years of age shall be allowed on the premises after 22:00 hours.

It is an offence to allow persons under the age of 16 years to be on the premises whilst it is open exclusively or primarily for the supply of alcohol for consumption on the premises unless they are accompanied by a person aged 18 or over. No unaccompanied person under the age of 16 years shall be permitted on the premises between 12 midnight and 5am if alcohol is supplied for consumption on the premises.

Licensing Service
Regulatory Services
Community Safety, Security and Resilience
222 Upper Street
London
N1 1XR
licensing@islington.gov.uk
020 7527 3031

GROUND

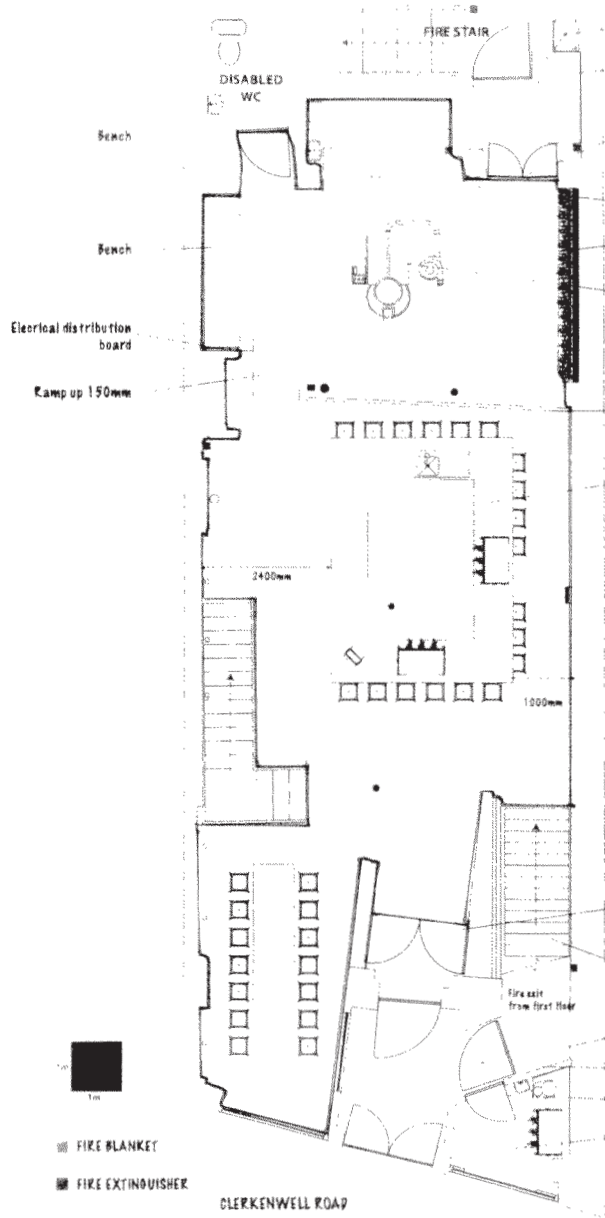

- Existing Food lift
- Stainless steel bench
- Existing fire doors
- Existing fire doors
- Ecologist particulate filter
- Plant Wall
- Probat 1.2kg coffee roaster
- Step 150mm
- Service Bar
- Existing auto fire door
- Stair to basement
- Existing fire door
- Existing fire door
- Fire door
- Take away coffee window

FIRST

